

LACRIJET® FOR CANALICULAR LACERATION REPAIR

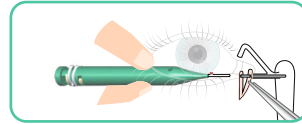

LacriJet® 15 mm and 20 mm have been specifically designed for canalicular laceration repair to prevent future canalicular obstruction due to scar tissue formation.

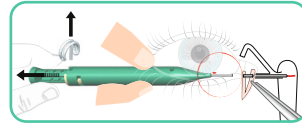

The LacriJet® is used like a metal probe to facilitate the catheterization between the distal and proximal portions of the canaliculus. The wound closure and sutures are therefore facilitated. The silicone tube is then released and left in place to avoid future blockage due to scar tissue.

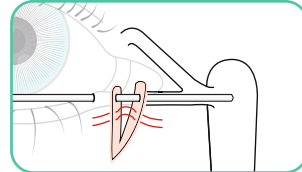

At the end of the procedure, it is important to make sure the fixation head is in contact with the punctum to avoid any risk of migration or extrusion of the silicone tube.

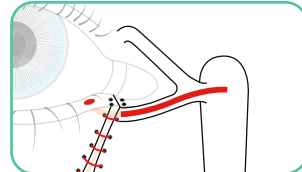

The fixation plug must be inserted into the punctum with the help of the plug inserter (S1.3090).

Once the plug is in place, the collarette should remain flush against the eyelid margin.

LACRIJET® ACCESSORIES

	PACKAGING
S1.1288 Sizer for LacriJet®	Box of 5
S1.3090 Punctum dilator and plug inserter	Box of 3

Marks for length selection

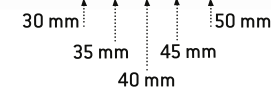

S1.1288

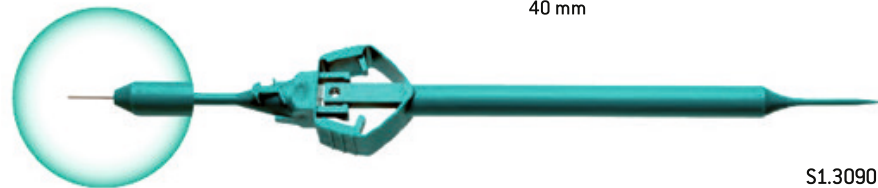

S1.3090

REFERENCES

		DIAMETER	LENGTH	PACKAGING	INDICATION
S1.1515	LacriJet®	0.64 mm	15 mm	Box of 1	Canalicular laceration
S1.1522	LacriJet®	0.64 mm	20 mm	Box of 1	
S1.1530	LacriJet®	0.64 mm	30 mm	Box of 1	
S1.1535	LacriJet®	0.64 mm	35 mm	Box of 1	
S1.1540	LacriJet®	0.64 mm	40 mm	Box of 1	Nasolacrimal stenosis
S1.1545	LacriJet®	0.64 mm	45 mm	Box of 1	
S1.1550	LacriJet®	0.64 mm	50 mm	Box of 1	

The LacriJet® (Class IIb), the sizer for LacriJet® (Class Is) and the punctum dilator and plug inserter (Class Is) are medical devices manufactured by FCI S.A.S. - Notified Body: GMED CE n°0459.

For more information
please contact your local distributor:



FCI S.A.S. 20/22 rue Louis Armand 75015 Paris (France) - Tel.: +33 1 53 98 98 97 - Fax: +33 1 53 98 98 99
Email: fciworldwide@fci.fr - www.fciworldwide.com

FCH18/008 Ind. C - Juillet 2022 - Société par Actions Simplifiées au Capital de 46 909 € - SIREN 951 670 385 - RCS PARIS



LACRIJET®

EXCLUSIVE

1st Preloaded & Self-Retaining Monocanalicular Nasolacrimal Intubation

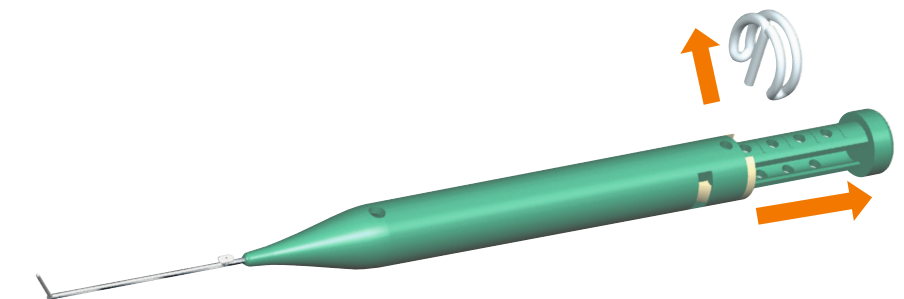

INDICATIONS

- Treatment of congenital nasocanalicular stenosis in children (12 months or over) and adults
- Monocanalicular or mono nasocanalicular stenosis with or without associated dacryocystorhinostomy (DCR) and in traumatology
- Canalicular laceration repair

LACRIJET®

LacriJet® is FCI latest and exclusive preloaded & self-retaining monocalicular nasolacrimal intubation indicated for epiphora, congenital nasolacrimal duct obstruction and canalicular laceration.

It consists of a single use injector handpiece into which a silicone tube is preloaded inside a metallic guide. LacriJet® has been specifically designed to reduce operating time, either in the intubation phase as well as for the removal of the device.

LacriJet® is first introduced into the nasolacrimal duct.

Once in position, the sliding piston is retracted and the silicone intubation is released.

It is maintained in place at the punctum by a plug-like fixation head: no nasal retrieval, no knots and no sutures are needed.

MAIN CHARACTERISTICS:

- Exclusive new injection system
- Silicone tube preloaded inside the metallic guide
- No nasal retrieval
- No knots
- No sutures
- Available in 7 lengths
- 3 mm plug collarette
- Requires sizer [S1.1288] to select the length & 0.3 mm disposable punctum dilator and plug inserter [S1.3090]
- Sterile, Single use

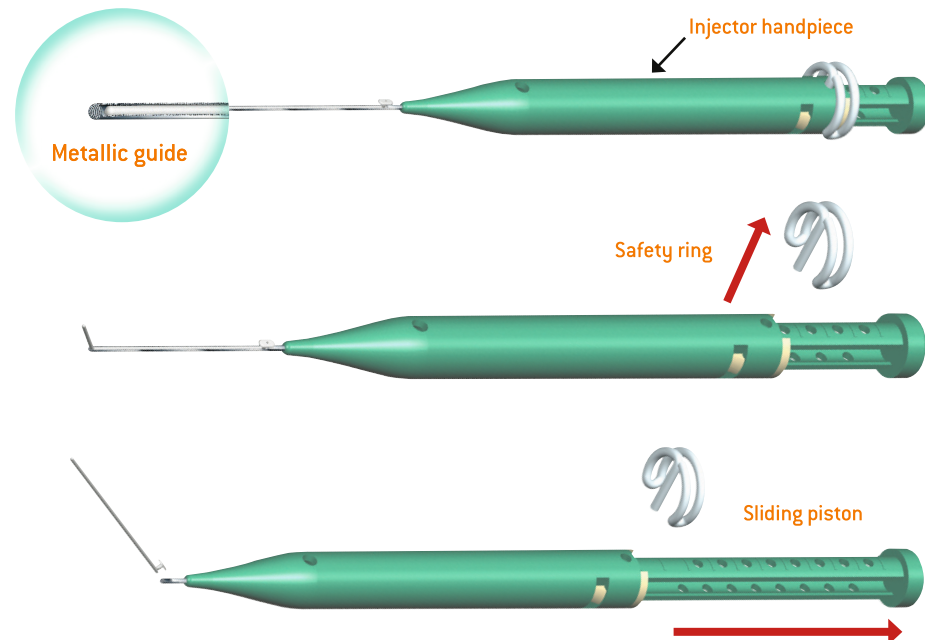

LACRIJET® FOR NASOLACRIMAL DUCT OBSTRUCTION

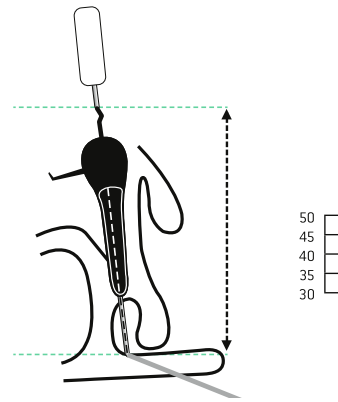

Initial probing & selection of the intubation length

- Dilatation of the punctum and insertion of a sizer ref. S1.1288.
- Search for bony contact.
- 90° rotation and vertical catheterization.
- Insert a second wider lacrimal probe with a blunt tip. Steer it very gently through the inferior nasal meatus **until metal-to-metal contact is achieved.**
- Select the appropriate LacriJet® length with the help of the black marks on the sizer.

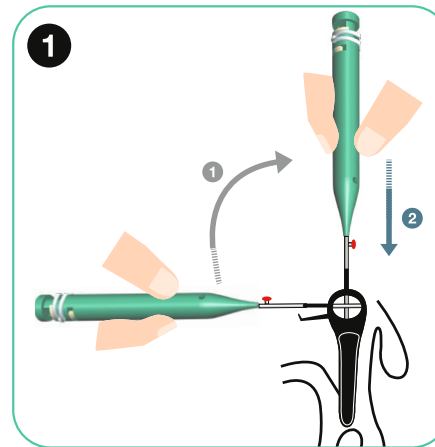

LacriJet® insertion

- Insert the LacriJet® into the punctum and through the canaliculus.
- Search for bony contact.
- 90° rotation and vertical catheterization until the nasal fossa is reached.

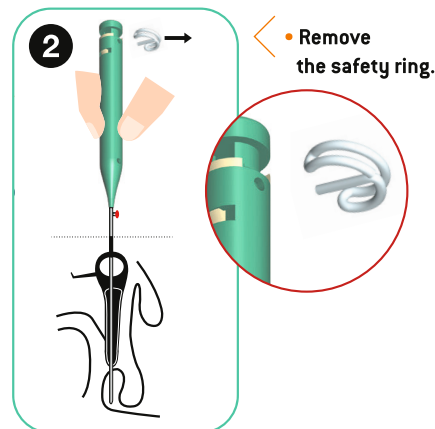

- Remove the safety ring.

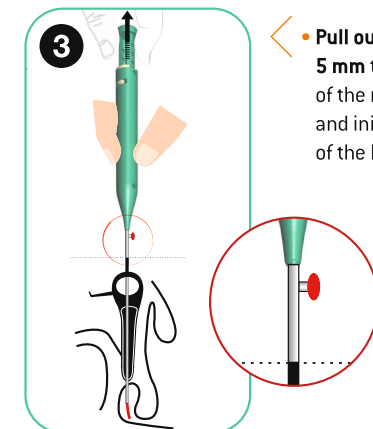

- Pull out the piston along 5 mm to retract the tip of the metallic probe and initiate the release of the LacriJet®.

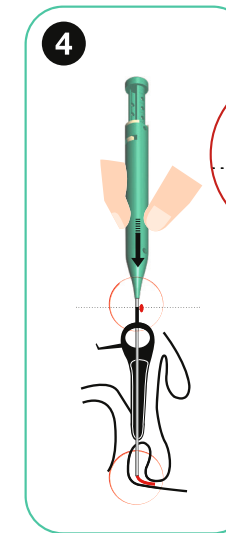

- Push further the injector into the nasolacrimal duct until the LacriJet® fixation plug comes in contact with the punctum.

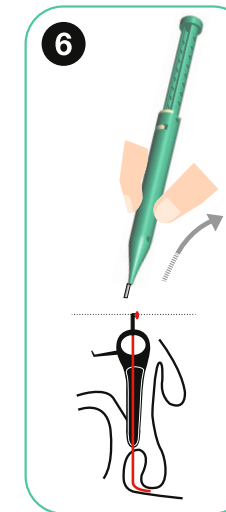

- It is important to make sure the fixation head is in contact with the punctum to avoid any risk of migration or extrusion of the silicone tube.

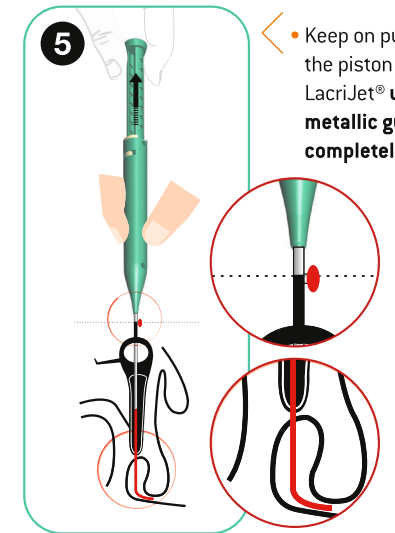

- Keep on pulling back the piston of the LacriJet® until the metallic guide is completely retracted.

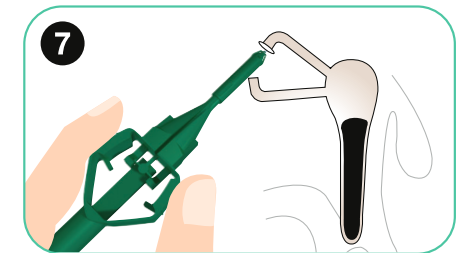

Plug insertion

- The fixation-plug must be inserted in the punctum with the help of the plug inserter [S1.3090].
- Once the plug is in place, the collarette should remain flush against the eyelid margin.

LacriJet® removal

- Hold the collarette of the fixation plug with the help of fine forceps and gently pull out the LacriJet® from the meatus and the lacrimal system.